



VICINITY MAP
SCALE: 1"=1,000'

GENERAL NOTES:

- DISPERSION TRENCHING SHALL BE CENTERED UNDER ROOF DRIP LINE WHERE THERE IS NO PROPOSED GRAVEL WALKWAY, PARKING COURT, PATIO OR OTHER MATERIAL THAT WILL KEEP ROOF RUNOFF FROM ERODING THE SOIL. THESE PROPOSED SURFACES SHALL BE SLOPED TO PROVIDE DRAINAGE AWAY FROM STRUCTURES.
- SILT FENCE SHALL BE LOCATED ON THE DOWN SLOPE SIDE OF ALL CONSTRUCTION ACTIVITY OR AS SHOWN.
- CONSTRUCT A NATURAL DISPERSION/DRAINAGE BASIN TO COLLECT ROOF RUNOFF AND ALLOW WATER TO INFILTRATE. AREA MAY BE OVER EXCAVATED AND FILLED WITH WASHED ROCK TO ALLOW A LEVEL SURFACE.
- EXPOSED AND UNWORKED SOILS SHALL BE TEMPORARILY OR PERMANENTLY STABILIZED AS SOON AS PRACTICABLE BY APPLICATION OF EFFECTIVE BEST MANAGEMENT PRACTICES (BMPs) THAT PROTECT THE SOIL FROM THE ERODIVE FORCES OF RAINDROPS, FLOWING WATER, AND WIND.
 - DURING THE DRY SEASON (JULY 1 THROUGH SEPTEMBER 30): 10 DAYS.
 - DURING THE WET SEASON (OCTOBER 1 THROUGH JUNE 30): 5 DAYS
 - SOIL STABILIZATION BMPs SHALL BE APPROPRIATE FOR THE SITE CONDITIONS, TIME OF YEAR, AND THE DURATION OF THE PROJECT.
 - SOIL STOCKPILES SHALL BE STABILIZED AND PROTECTED WITH EROSION AND SEDIMENT CONTROL BMPs.
- NO SOILS SHOULD REMAIN EXPOSED AND UNWORKED FOR MORE TIME THAN THE TIME PERIODS SET FORTH BELOW TO PREVENT WIND AND WATER EROSION. THIS STABILIZATION REQUIREMENT APPLIES TO ALL SOILS ON SITE, WHETHER AT FINAL GRADE OR NOT.

MALSAM RESIDENCE
SECTION 44, T. 21 N., R14 E., W.M.
KITITITAS COUNTY, STATE OF WASHINGTON

PROPERTY INFORMATION:

OWNER: JEREMY MALSAM
ENGINEER/SURVEYOR: ENCOMPASS ENGINEERING & SURVEYING
407 SWIFTWATER BLVD
CLE ELUM, WA 98922
PHONE: 509-674-7433
CONTACT: BRUCE NOBLE, PE
PARCEL NUMBER: 20344 (21-14-34010-0025)
PARCEL SIZE: 3.02 ACRES
PROPERTY ADDRESS: UNKNOWN
ZONE: RURAL RECREATION

SHEET INDEX:

TITLE	
COVER SHEET	C0.0
GRADING & TESC PLAN	C1.0
SECTION VIEWS	C1.1
SITE PLAN	C2.0

ABBREVIATIONS:

AC - ASPHALT CONCRETE
ACP - ABESTOS CEMENT PIPE
ADD'L - ADDITIONAL
AD - AREA DRAIN
ADJ - ADJACENT
ANSI - AMERICAN NATIONAL STANDARDS INSTITUTE
ALT - ALTERNATE
ALUM - ALUMINUM
APPROX - APPROXIMATE(LY)
ARCH - ARCHITECT(URAL)
AP - ANGLE POINT
ASPH - ASPHALT
ASSY - ASSEMBLY
ASTM - AMERICAN SOCIETY OF TESTING AND MATERIALS
AVE - AVENUE
BC - BACK OF CURB
BF - BLIND FLANGE
BLDG - BUILDING
BLDC - BUILDING CORNER
BLK - BLOCK
BLVD - BOULEVARD
BM - BENCHMARK
BNDY - BOUNDARY
BO - BLOW OFF
BOW - BOTTOM OF WALL (AT FINISHED GRADE)
BSBL - BUILDING SETBACK LINE
BVC - BEGINNING OF VERTICAL CURVE
BVCE - BEGIN VERTICAL CURVE ELEVATION
BVCS - BEGIN VERTICAL CURVE STATION
BW - BACK OF WALK
CB - CATCH BASIN
CF - CUBIC FEET (FOOT)
CIP - CAST IRON PIPE
CJ - CONSTRUCTION JOINT
CL - CLASS
C/L - CENTER LINE
CLR - CLEARANCE
CMP - CORRUGATED METAL PIPE
CO - CLEAN OUT
CONN - CONNECTION
CONT - CONTINUOUS (CONTINUED)
CONTR - CONTRACTOR
C, CONC - CONCRETE
CONST - CONSTRUCTION
CP - CONTROL POINT
CFS - CUBIC FEET PER SECOND
CTR - CENTER(ED)
CTV - CABLE TV
C&G - CURB AND GUTTER
CY - CUBIC YARD
DCVA - DOUBLE CHECK VALVE ASSEMBLY
DDCV - DOUBLE DETECTOR CHECK VALVE
DEPT. - DEPARTMENT
DET - DETAIL OR DETENTION
DIP - DUCTILE IRON PIPE
DIA(S) - DIAMETER
DIM - DIMENSION
DOT - DEPARTMENT OF TRANSPORTATION
DS - DOWN SPOUT
DWG - DRAWING
E - EAST(ING)
EA - EACH
EL - ELEVATION
ELEC - ELECTRICAL
EP - EDGE OF PAVEMENT
EQUIV - EQUIVALENT
EVC - END OF VERTICAL CURVE
EVCE - END OF VERTICAL CURVE ELEVATION
EVCS - END OF VERTICAL CURVE STATION
EX, EXIST - EXISTING
FC - FACE OF CURB
FD - FLOOR DRAIN
FDC - FIRE DEPARTMENT CONNECTION
FFE - FINISH FLOOR ELEVATION
FH - FIRE HYDRANT
FL - FLANGED OR FLOW LINE
FLR - FLOOR
FS - FINISHED SURFACE
FT (') - FOOT (FEET)
FTG - FOOTING

G - GAS MAIN
GA - GAUGE
GALV - GALVANIZED
GB - GRADE BREAK
GM - GAS METER
GRD - GRADE
HB - HOSE BIBB
HDPE - HIGH DENSITY POLYETHYLENE
L - LENGTH
LB # - POUND(S)
LF - LINEAR FEET
LN - LANE
MAT'L - MATERIAL
MAX - MAXIMUM
MFR - MANUFACTURER
MH - MANHOLE
MIN - MINIMUM
MISC - MISCELLANEOUS
MJ - MECHANICAL JOINT
N - NORTH(ING)
NO (#) - NUMBER
N.T.S. - NOT TO SCALE
O.C. - ON CENTER
O.D. - OUTSIDE DIAMETER
O/W - OIL WATER
P - POWER
PC - POINT OF CURVATURE
PERF - PERFORATED
PI - POINT OF INTERSECTION
PIV - POST INDICATOR VALVE
PL - PROPERTY LINE
PP - POWER POLE
PROV - PROVIDED
PSF - POUNDS PER SQUARE FOOT
PSI - POUNDS PER SQUARE INCH
PT - POINT OF TANGENCY
PVC - POLYVINYL CHLORIDE
PVI - POINT OF VERTICAL INTERSECTION
PVMT - PAVEMENT
PVT - POINT OF VERTICAL TANGENT
QTY - QUANTITY
RAD (R) - RADIUS
RCP - REINFORCED CONCRETE PIPE
RD - ROAD
REF - REFERENCE
REINF - REINFORCED
REQ - REQUIRED
RET - RETAINING
ROW - RIGHT-OF-WAY
RR - RAILROAD
S - SOUTH
S, SL - SLOPE
SCH - SCHEDULE
SD - STORM DRAIN
SF - SQUARE FOOT
SHT - SHEET
SIM - SIMILAR
SPEC - SPECIFICATION(S)
SQ - SQUARE
SS - SANITARY SEWER
ST - STREET
STA - STATION
STD - STANDARD
STL - STEEL
T - TELEPHONE WIRE
TBM - TEMPORARY BENCH MARK
TC - TOP OF CURB
TEMP - TEMPORARY
TG/RIM - TOP OF GRATE/RIM
THRU - THROUGH

TOE - TOE OF WALL OR SLOPE
TOP - TOP OF WALL OR SLOPE
TOW - TOP OF WALL
TYP - TYPICAL
VC - VERTICAL CURVE
VOL - VOLUME
W - WEST
W/ - WITH
WM - WATER METER
W/O - WITHOUT
WQ - WATER QUALITY
WT - WEIGHT
WWF - WELDED WIRE FABRIC
WV - WATER VALVE
YD - YARD DRAIN

REVISIONS	DESCRIPTION	BY	DATE

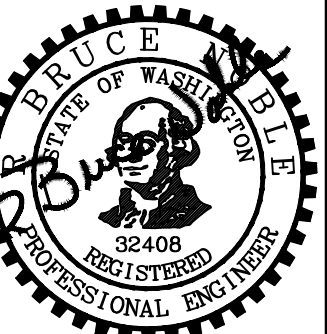

10/13/2021

MALSAM RESIDENCE
JEREMY MALSAM
COVER SHEET



INDEX LOCATION
SEC. 34 T. 21N R. 14E W.M.

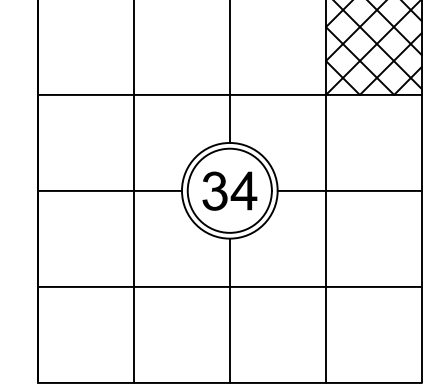

Know what's below.
Call before you dig.

JOB NO.	21199
DATE	OCT 2021
SCALE	AS SHOWN
DESIGNED	TJS
DRAWN	TJS
CHECKED	RBN
APPROVED	RBN

SHEET C0.0

MALSAM RESIDENCE
SECTION 44, T. 21 N., R14 E., W.M.
KITITITAS COUNTY, STATE OF WASHINGTON

CUT AND FILL CALCULATIONS
APPROXIMATE CUT: 429 CUBIC YDS
APPROXIMATE FILL: 359 CUBIC YDS
NET: 69 CUBIC YDS CUT

RECOMMENDED CONSTRUCTION SEQUENCE:

1. PRE-CONSTRUCTION MEETING.
2. INSTALL CATCH BASIN PROTECTION IF REQUIRED.
3. GRADE AND INSTALL CONSTRUCTION ENTRANCE(S).
4. INSTALL PERIMETER PROTECTION (SILT FENCE, BRUSH BARRIER, ETC.).
5. GRADE DRAINAGE SWALES AND INSTALL CHECK DAMS, IF REQUIRED.
6. INSTALL CULVERT INLET AND OUTLET PROTECTION AS NEEDED.
7. GRADE AND STABILIZE CONSTRUCTION ROADS.
8. CONSTRUCT SURFACE WATER CONTROLS (INTERCEPTOR DIKS, PIPE SLOPE DRAINS, ETC.). SIMULTANEOUSLY WITH CLEARING AND GRADING FOR PROJECT DEVELOPMENT, IF REQUIRED.
9. MAINTAIN EROSION CONTROL MEASURES IN ACCORDANCE WITH PLANS & DOE "BEST MANAGEMENT PRACTICES"
10. RELOCATE EROSION CONTROL MEASURES OR INSTALL NEW MEASURES SO THAT AS SITE CONDITIONS CHANGE THE EROSION AND SEDIMENT CONTROL IS ALWAYS IN CONFORMANCE.
11. COVER ALL AREAS THAT WILL BE UNWORKED FOR MORE THAN TEN DAYS DURING THE DRY SEASON OR FIVE DAYS DURING THE WET SEASON WITH STRAW, WOOD FIBER MULCH, COMPOST, PLASTIC SHEETING OR EQUIVALENT.
12. STABILIZE ALL AREAS THAT REACH FINAL GRADE WITHIN SEVEN DAYS.
13. SEED OR SOD ANY AREAS TO REMAIN UNWORKED FOR MORE THAN 30 DAYS.
14. UPON COMPLETION OF THE PROJECT, ALL DISTURBED AREAS MUST BE STABILIZED AND BMPs REMOVED IF APPROPRIATE.

PARCEL 8

LEGEND

- EXISTING MAJOR CONTOUR
- - - EXISTING MINOR CONTOUR
- PROPOSED MAJOR CONTOUR
- - - PROPOSED MINOR CONTOUR

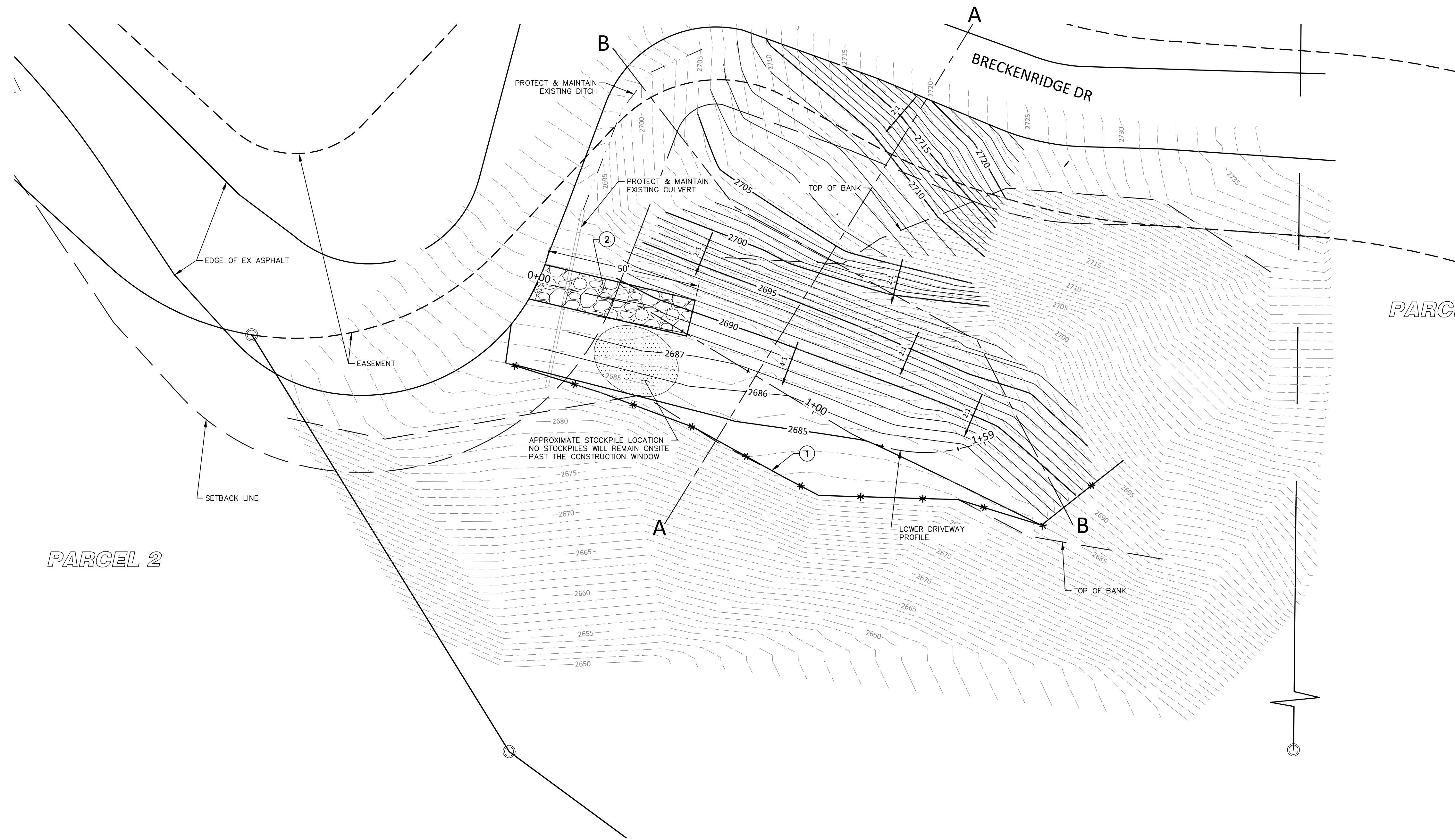

PARCEL 2

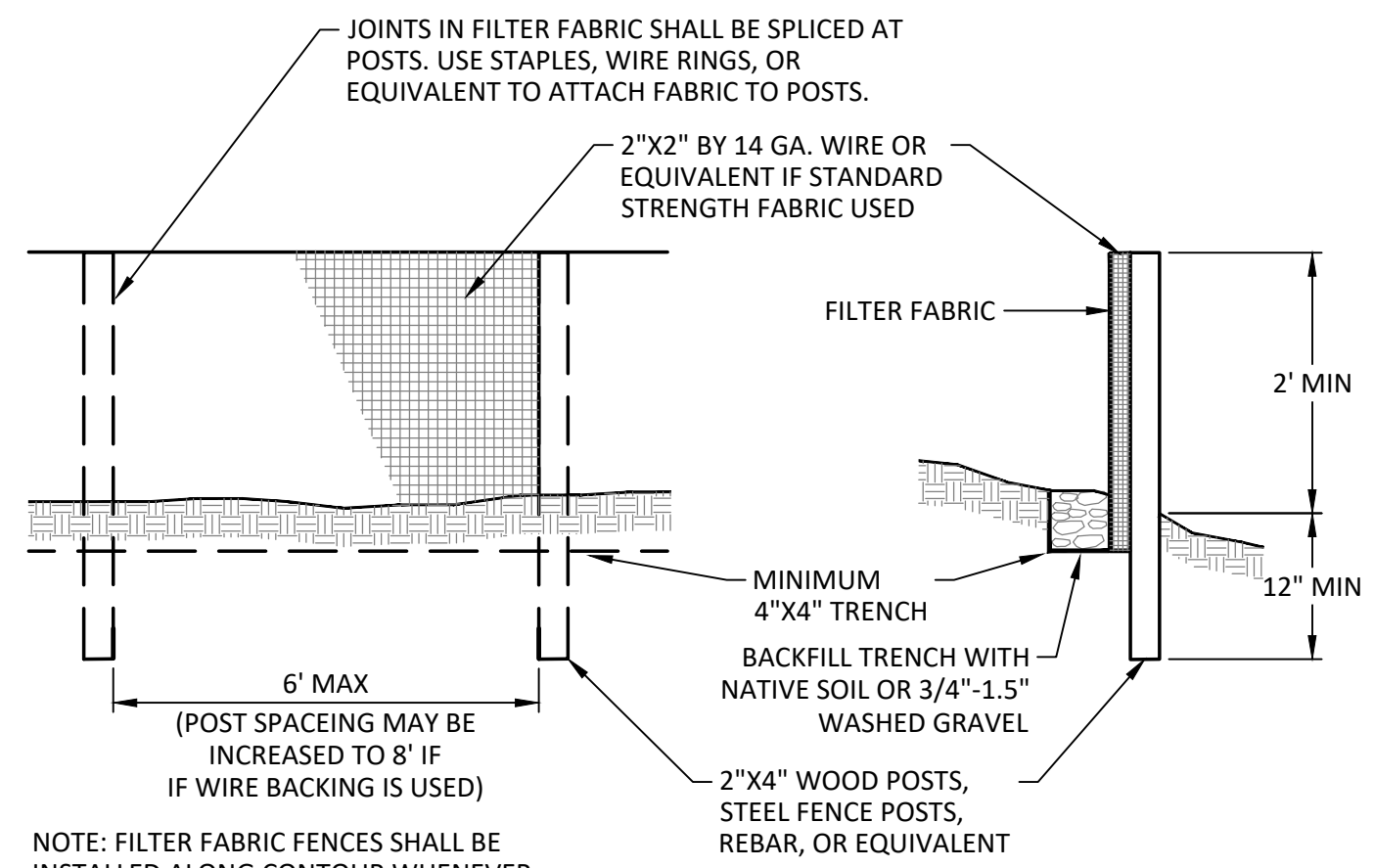

1 SILT FENCE
N.T.S.

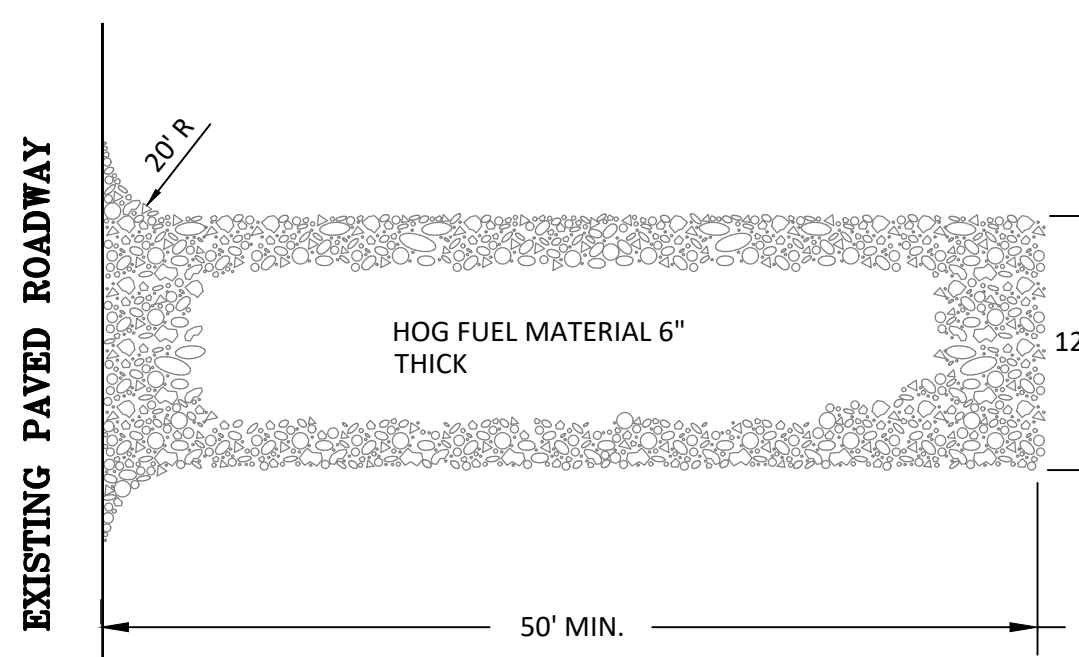

2 HOG FUEL CONSTRUCTION ENTRANCE
N.T.S.

NOTES:

1. THE ENTRANCE SHALL BE MAINTAINED IN A CONDITION THAT WILL PREVENT TRACKING OR FLOWING OF SEDIMENT ONTO PUBLIC RIGHTS- OF-WAY. THIS MAY REQUIRE TOP DRESSING, REPAIR AND/OR CLEANOUT OF ANY MEASURES USED TO TRAP SEDIMENT.
2. WHEN NECESSARY, WHEELS SHALL BE CLEANED PRIOR TO ENTRANCE ONTO PUBLIC RIGHT-OF-WAY.
3. WHEN WASHING IS REQUIRED, IT SHALL BE DONE ON AN AREA STABILIZED WITH CRUSHED STONE THAT DRAINS INTO AN APPROVED SEDIMENT TRAP OR SEDIMENT BASIN.

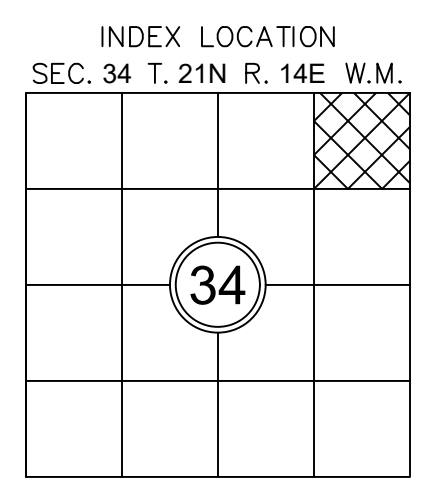
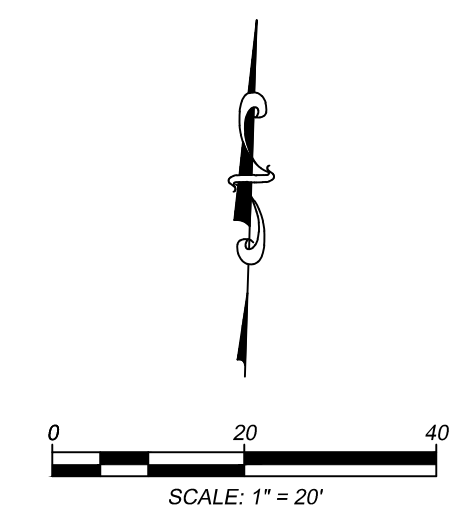

REVISIONS	DESCRIPTION	BY	DATE

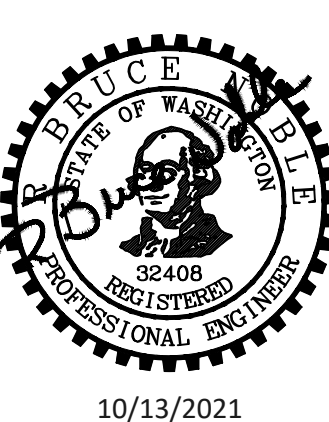

10/13/2021

MALSAM RESIDENCE
JEREMY MALSAM
GRADING & TESC PLAN

Encompass
ENGINEERING & SURVEYING
Western Washington Division
165 NE Juniper Street, Suite 200
Everett, Washington 98201
407 Swiftwater Blvd. • Clk. Elem. WA 98922 • Phone: (509) 674-7433

JOB NO.	21199
DATE	OCT 2021
SCALE	AS SHOWN
DESIGNED	TJS
DRAWN	TJS
CHECKED	RBN
APPROVED	RBN

SHEET **C1.0**

U:\21\21199\ENGINEERING\GRADING\PLAN_SHEETS\21199_TESC.dwg 10/13/2021 12:11:08 PM

MALSAM RESIDENCE
SECTION 44, T. 21 N., R14 E., W.M.
KITITAS COUNTY, STATE OF WASHINGTON

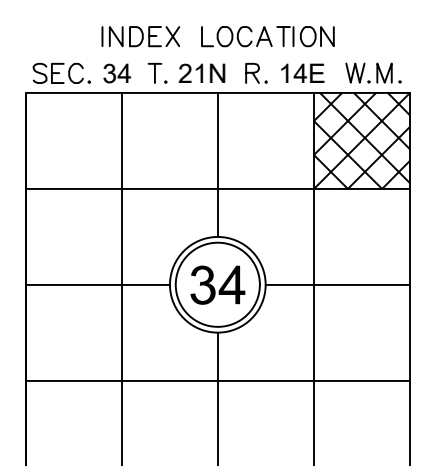
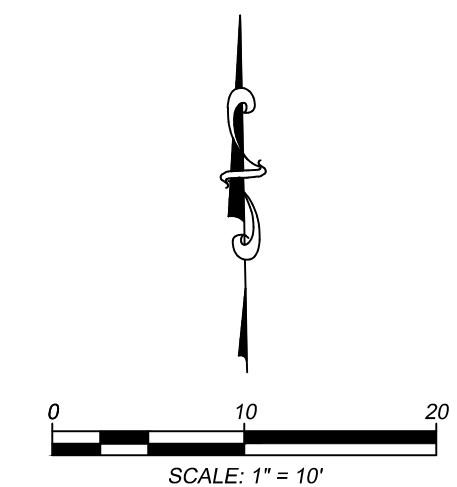
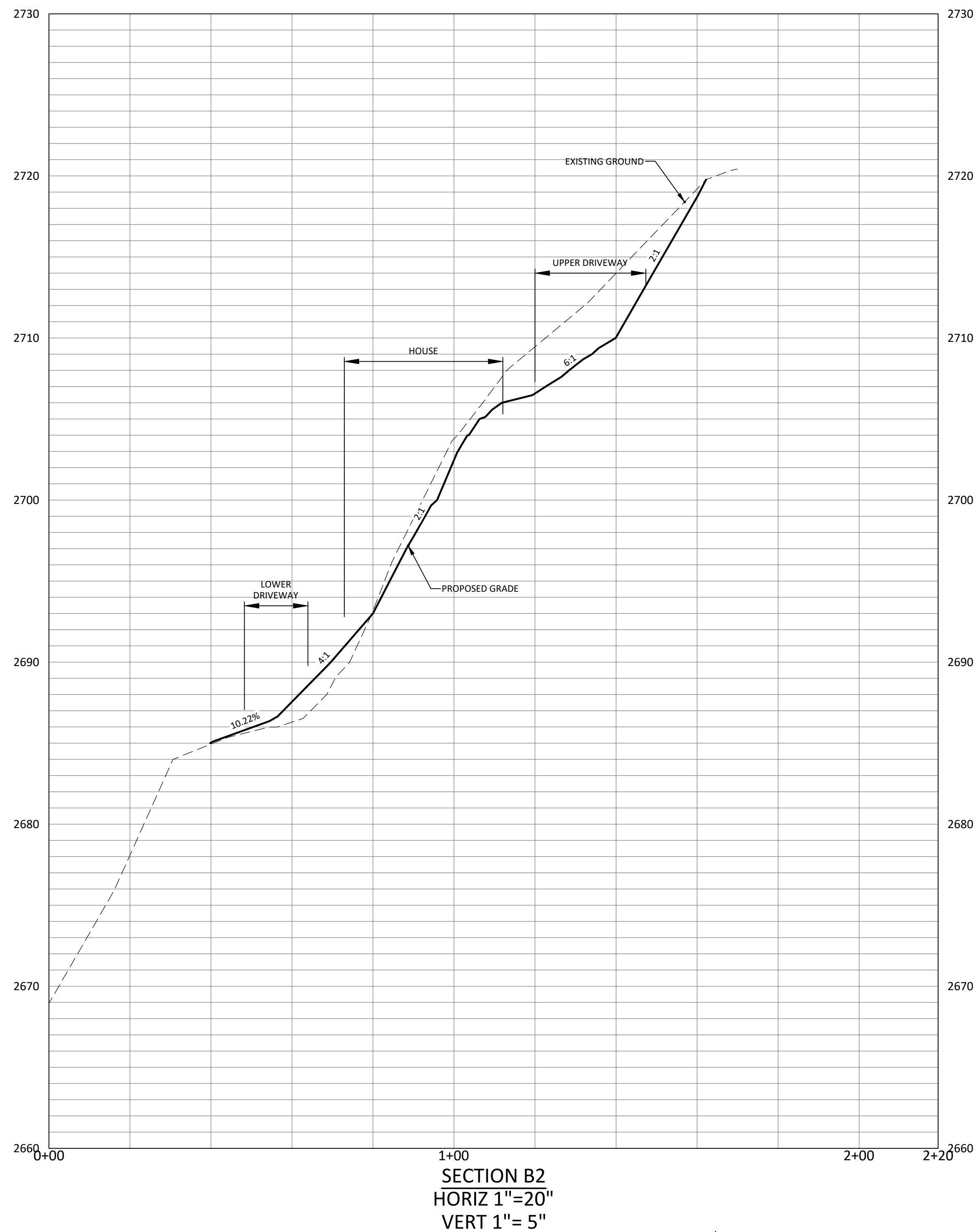
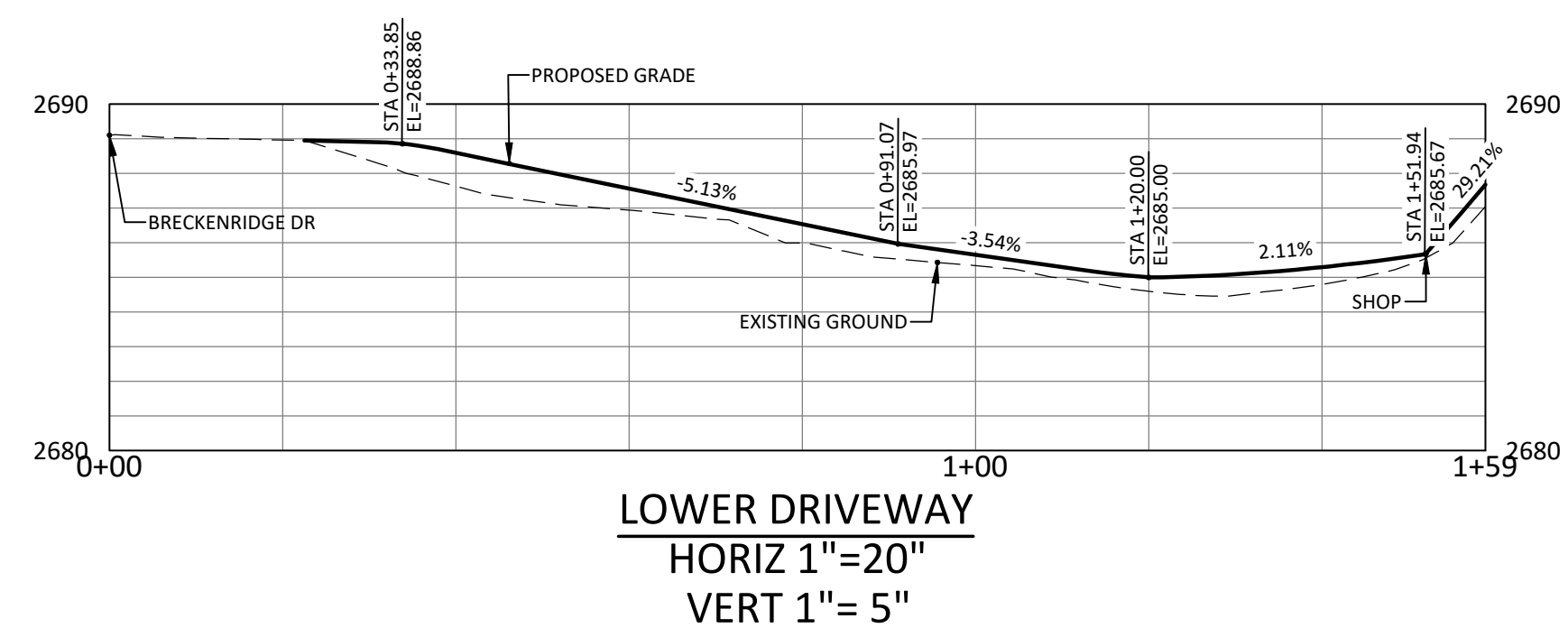
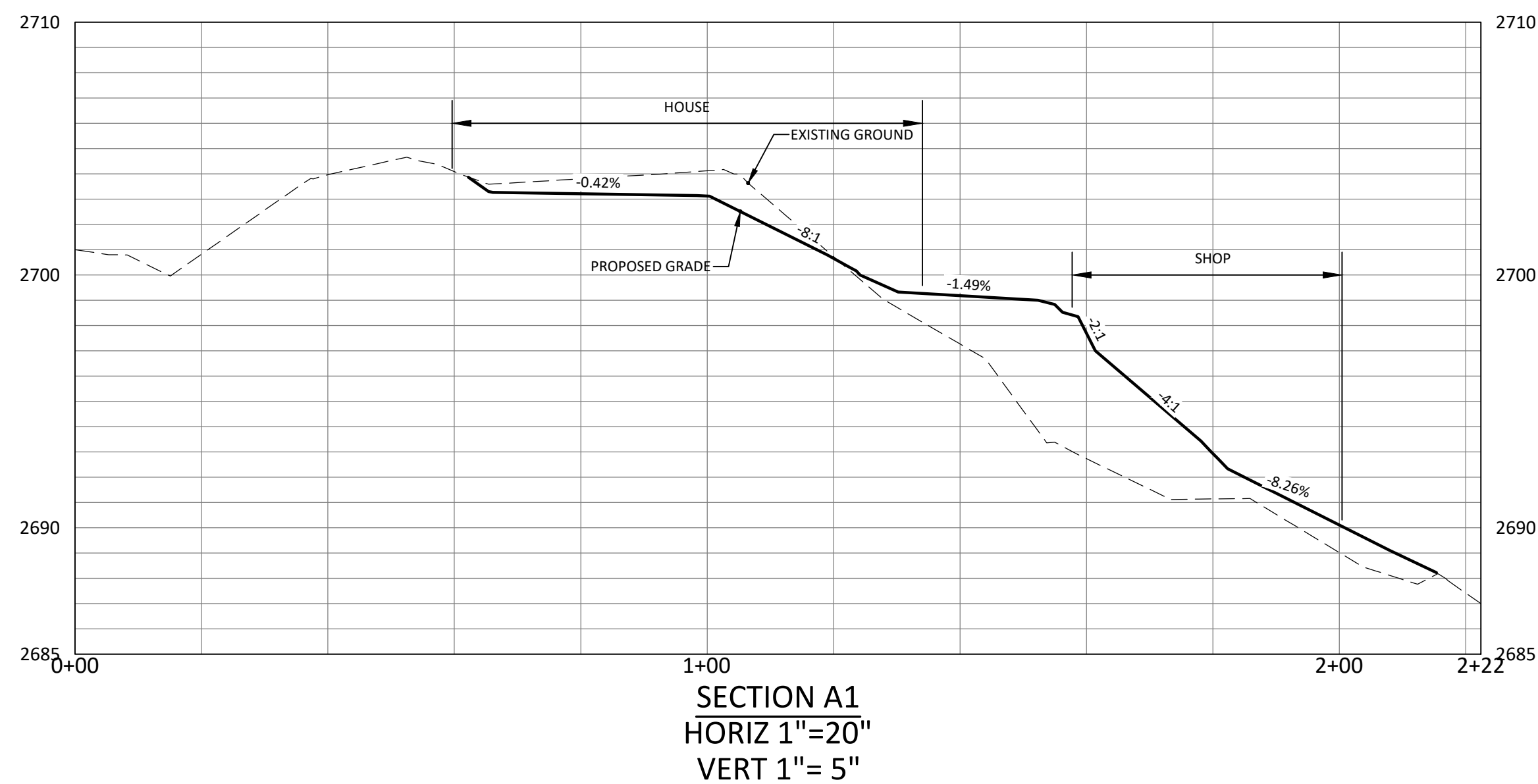

DESCRIPTION	BY	DATE

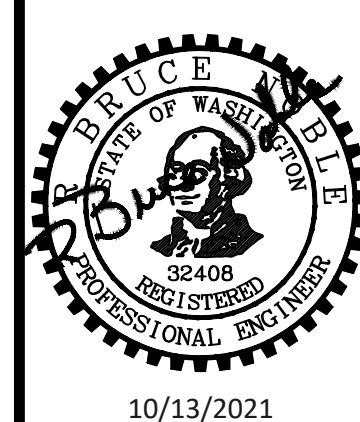

10/13/2021

MALSAM RESIDENCE
JEREMY MALSAM
SECTION VIEWS

Encompass
ENGINEERING & SURVEYING
Western Washington Division
165 NE Juniper Street, Suite 200
Everett, Washington 98201
407 Swiftwater Blvd. • Clk. Elum, WA 98922 • Phone: (509) 674-7433

JOB NO.	21199
DATE	OCT 2021
SCALE	AS SHOWN
DESIGNED	TJS
DRAWN	TJS
CHECKED	RBN
APPROVED	RBN
SHEET	C1.1

THE PLANS SET FORTH ON THIS SHEET ARE AND SHALL REMAIN THE PROPERTY OF ENCOMPASS ENGINEERING & SURVEYING.

U:\21199\ENGINEERING\DWG\21199_TB.dwg 10/13/2021 12:33:14 PM

MALSAM RESIDENCE
SECTION 44, T. 21 N., R14 E., W.M.
KITITAS COUNTY, STATE OF WASHINGTON

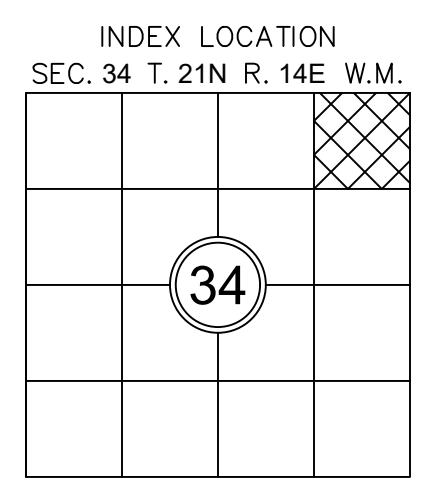
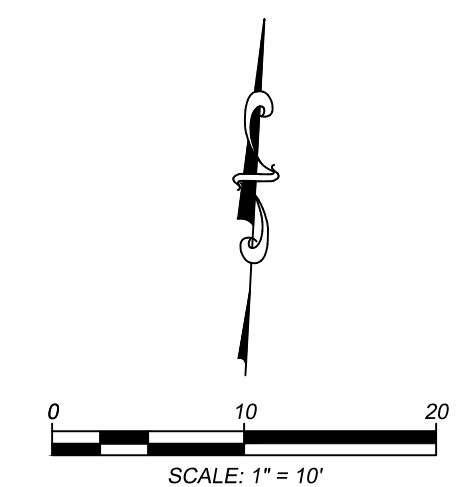
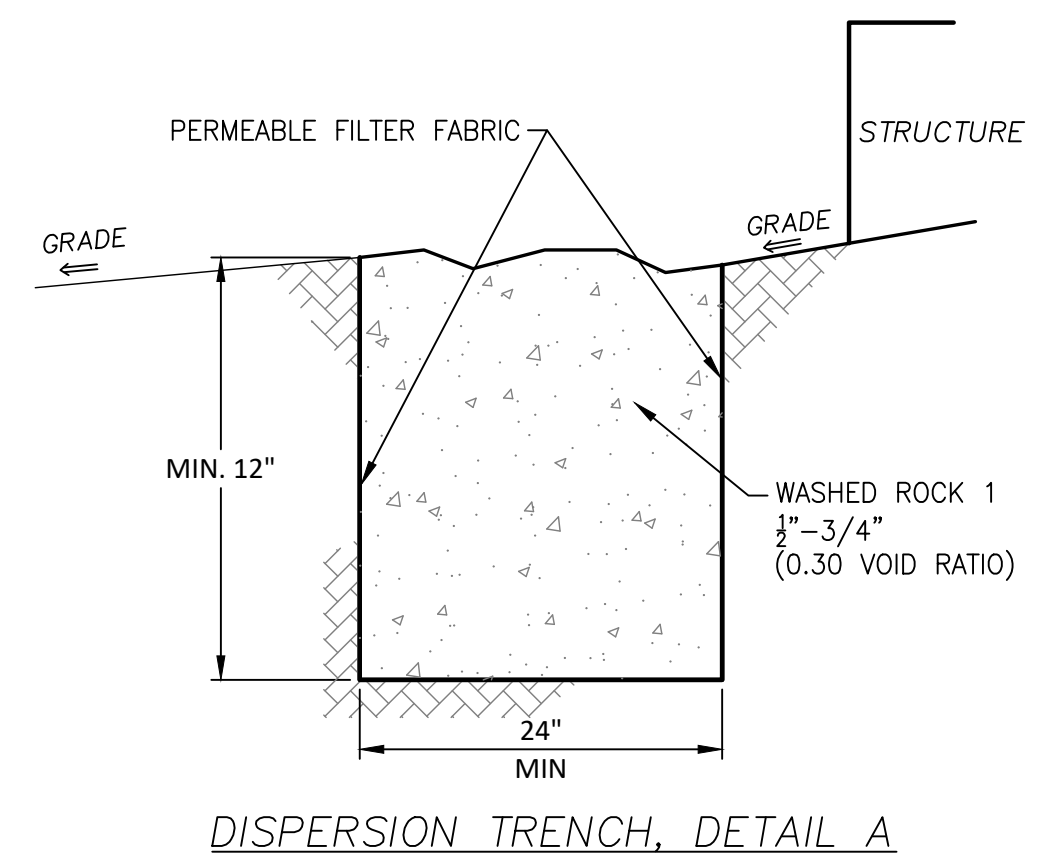
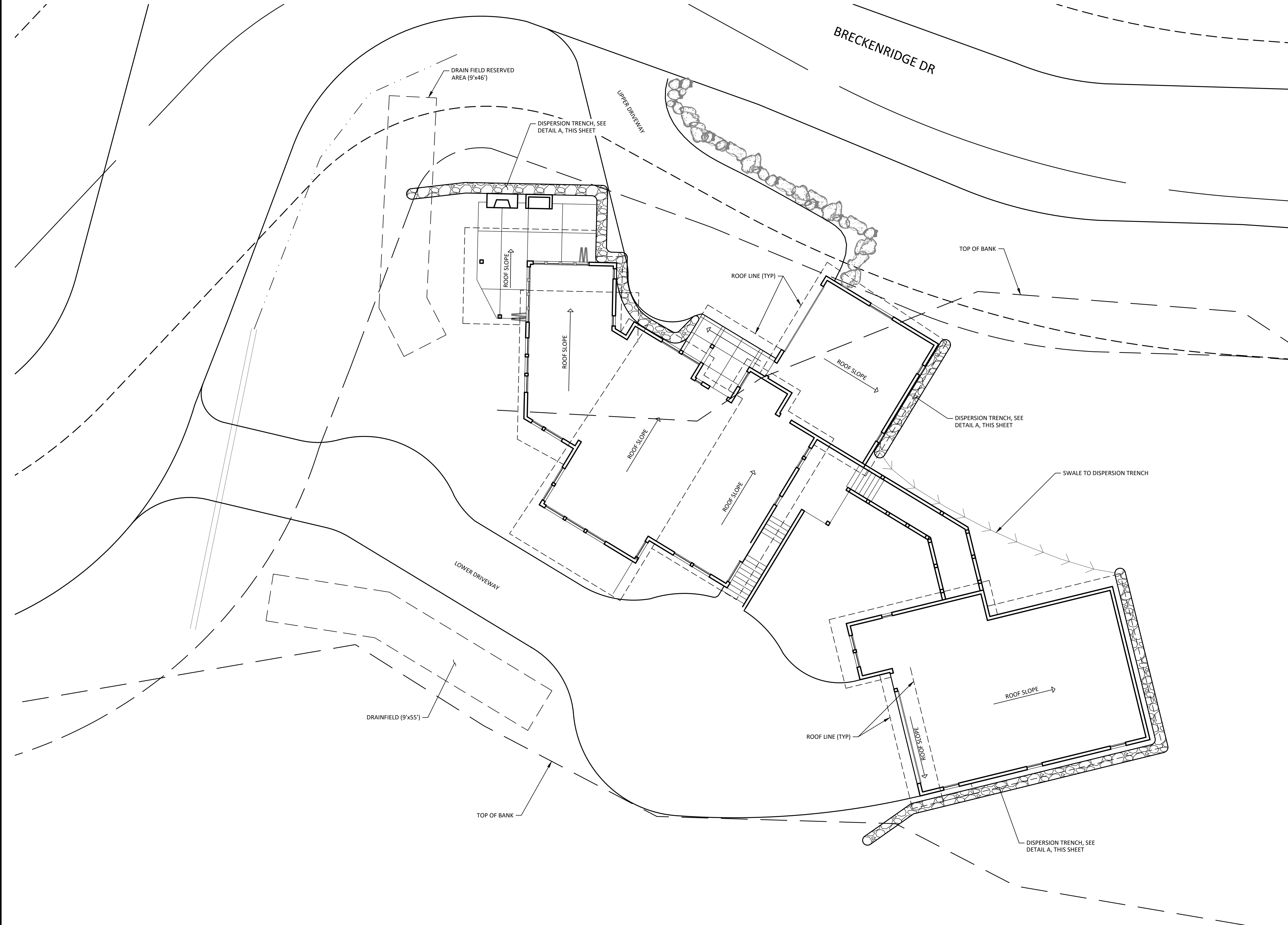

REVISIONS	DESCRIPTION	BY	DATE

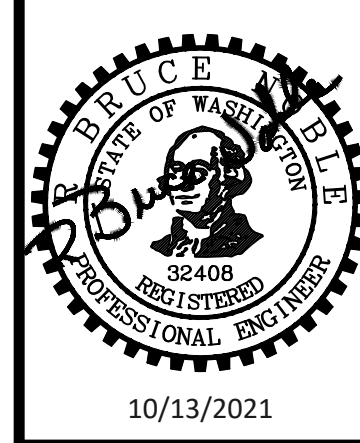

MALSAM RESIDENCE
JEREMY MALSAM
SITE PLAN

Encompass
ENGINEERING & SURVEYING

Western Washington Division
165 NE Juniper Street, Suite 200
Everett, WA 98201 • Phone: (425) 392-0250
Eastern Washington Division
407 Swiftwater Blvd. • Clk. Elm., WA 98922 • Phone: (509) 674-7433

JOB NO.	21199
DATE	OCT 2021
SCALE	AS SHOWN
DESIGNED	TJS
DRAWN	TJS
CHECKED	RBN
APPROVED	RBN
SHEET	C2.0

J:\21199\ENGINEERING\GRADING\PLAN SHEETS\21199 GRADING.dwg 10/13/2021 12:01:14 PM